

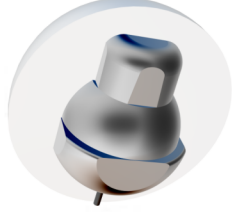

COLOR Black
 COVERSTOCK: Urethane
 FACTORY FINISH: 500 Abralon@
 BEST LANE CONDITION: Med. to Light
 CORE: LED
 AVAILABLE WEIGHTS: 14-16 lbs.

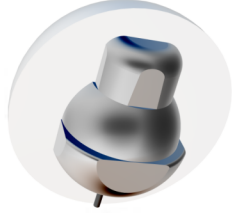

COLOR Black
 COVERSTOCK: Urethane
 FACTORY FINISH: 500 Abralon@
 BEST LANE CONDITION: Med. to Light
 CORE: LED
 AVAILABLE WEIGHTS: 14-16 lbs.



COLOR Black
 COVERSTOCK: Urethane
 FACTORY FINISH: 500 Abralon@
 BEST LANE CONDITION: Med. to Light
 CORE: LED
 AVAILABLE WEIGHTS: 14-16 lbs.

RG / DIFFERENTIAL
 #16 RG (2.61) Diff (.030)
 #15 RG (2.65) Diff (.015)
 #14 RG (2.68) Diff (.013)

RG / DIFFERENTIAL
 #16 RG (2.61) Diff (.030)
 #15 RG (2.65) Diff (.015)
 #14 RG (2.68) Diff (.013)

RG / DIFFERENTIAL
 #16 RG (2.61) Diff (.030)
 #15 RG (2.65) Diff (.015)
 #14 RG (2.68) Diff (.013)

OUT OF BOX CHARACTERISTICS

▶ There isn't a person on this planet that will argue against the fact that Hammer made the best urethane bowling balls back in the day. Bowlers looking for the ball reaction that dominated the 80's & early 90's will find it in our new Black Urethane!

More Info: hammerbowling.com
Flip Cards: bowlingdisplays.com

OUT OF BOX CHARACTERISTICS

▶ There isn't a person on this planet that will argue against the fact that Hammer made the best urethane bowling balls back in the day. Bowlers looking for the ball reaction that dominated the 80's & early 90's will find it in our new Black Urethane!

More Info: hammerbowling.com
Flip Cards: bowlingdisplays.com

OUT OF BOX CHARACTERISTICS

▶ There isn't a person on this planet that will argue against the fact that Hammer made the best urethane bowling balls back in the day. Bowlers looking for the ball reaction that dominated the 80's & early 90's will find it in our new Black Urethane!

More Info: hammerbowling.com
Flip Cards: bowlingdisplays.com